

VARiOX®-Kabelkanal · VARiOX®-Trunking

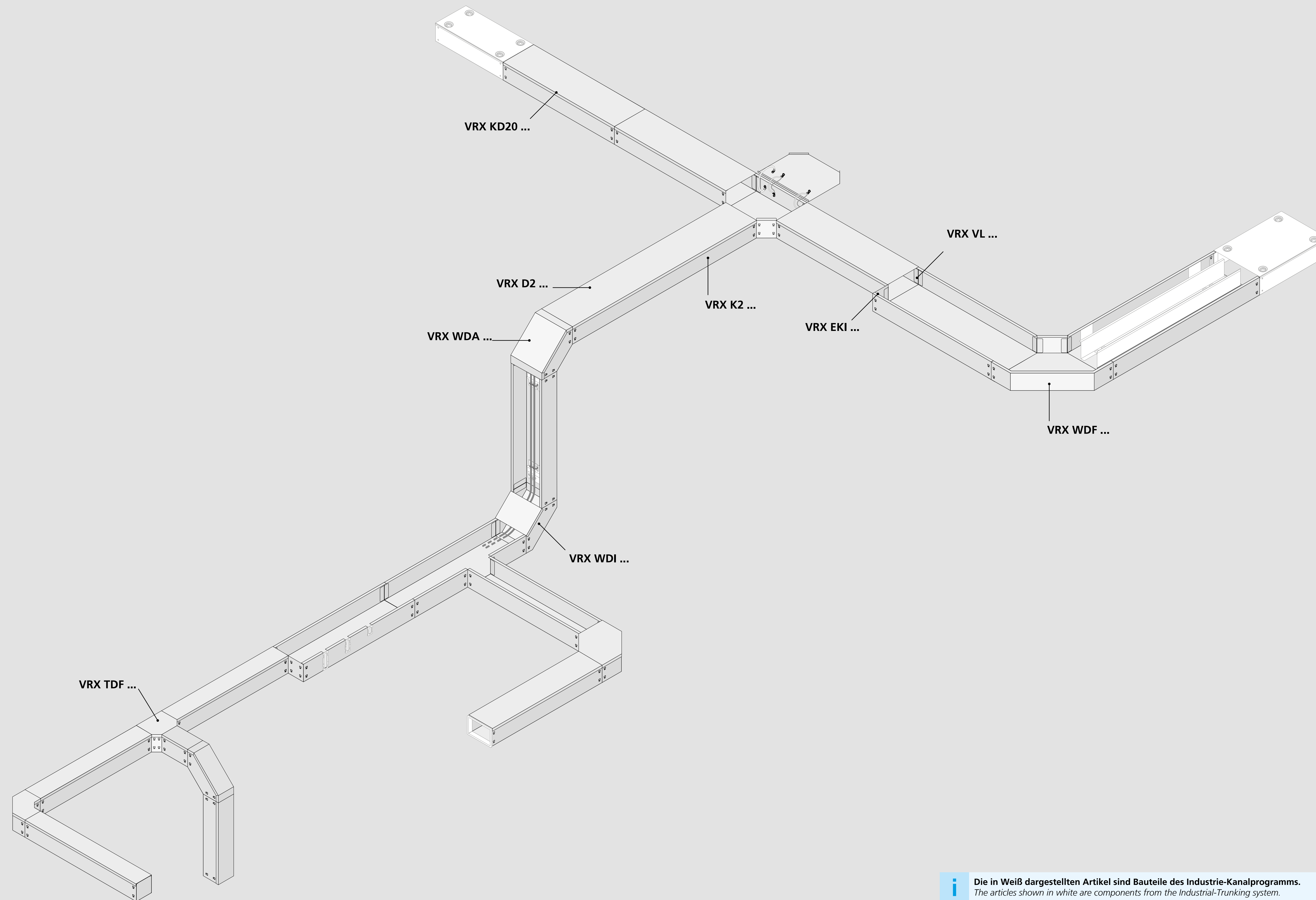

Passion for the best solution
 PFLITSCH GmbH & Co. KG
 Ernst-Pflitsch-Straße 1 Nord 1
 D-42499 Hückeswagen
 Telefon: +49 2192 911-0
 Fax: +49 2192 911-220
 E-Mail: info@pflitsch.de
 Internet: www.pflitsch.de



i Die in Weiß dargestellten Artikel sind Bauteile des Industrie-Kanalprogramms.
 The articles shown in white are components from the Industrial-Trunking system.

Produktübersicht: VARiOX®-Kabelkanal und Zubehör

Overview: VARiOX®-Trunking and accessories

| | | | | | | | | | | |
|--|--|---------------------------------|--|---|---|---|--|---|---|-----|
| | | | | | | | | | | SUM |
| VARiOX®-Kabelkanal: Körper + Deckel VARiOX® Cable trunking: body + cover | VARiOX®-Kabelkanal-Körper VARiOX® Cable trunking body | VARiOX®-Deckel VARiOX® Cover | VARiOX®-Winkel, Deckel in Flucht VARiOX® 90° Gusset, top access | VARiOX®-T-Stück, Deckel in Flucht VARiOX® T connection, top access | VARiOX®-Winkel, Deckel Außen VARiOX® 90° Gusset, external access | VARiOX®-Winkel, Deckel Innen VARiOX® 90° Gusset, internal access | VARiOX®-Endkappe Innen VARiOX® Internal end cap | VARiOX®-Schnellverbinder VARiOX® Quick Connector | Schrauben und Muttern Bolts and nuts | |
| VRX KD20 | VRX K2 | VRX D2 | VRX WDF | VRX TDF | VRX WDA | VRX WDI | VRX EKI | VRX VL | | |

VARiOX®-Kabelkanal · VARiOX®-Trunking



Passion for the best solution

PFLITSCH GmbH & Co. KG
 Ernst-Pflitsch-Straße 1 Nord 1
 D-42499 Hückeswagen
 Telefon: +49 2192 911-0
 Fax: +49 2192 911-220
 E-Mail: info@pflitsch.de
 Internet: www.pflitsch.de

Bearbeitung von Kabelkanälen und Vorstellung von Maschinen und Werkzeugen Processing of trunking and presentation of machines and tools

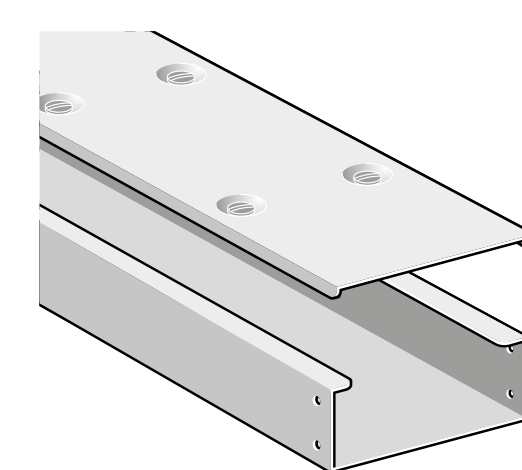

Industrie-Kanal
Industrial-Trunking

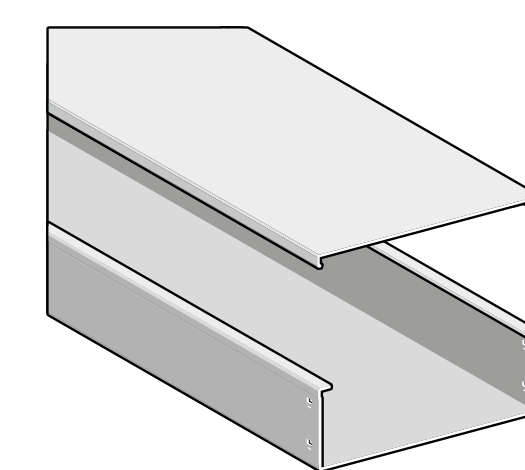

VARiOX®-Kanal
VARiOX®-Trunking

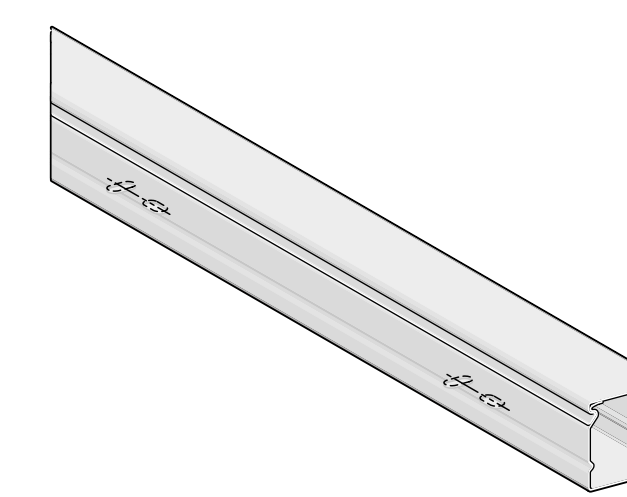

PIK-Kanal
PIK-Trunking

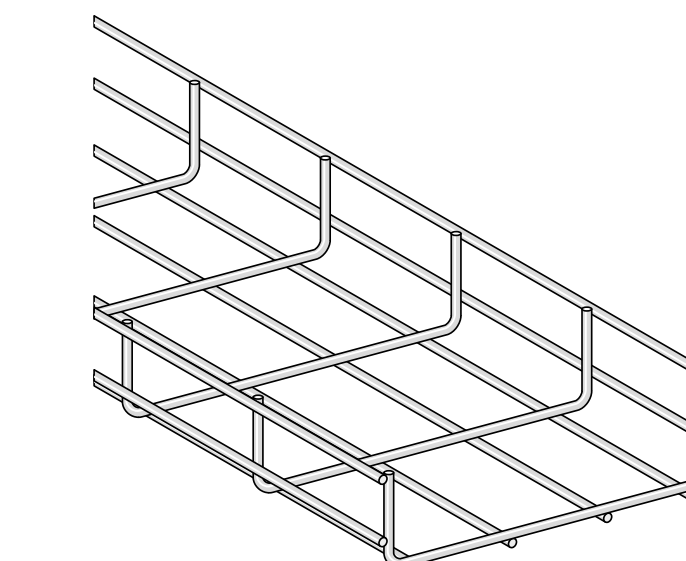

Gitter-Kanal
Wire-Tray Trunking

Maschinen Machines

| Art. Nr. Art. no | Werkzeuge Tools | | | |
|--|---|--|--|--------------------------------------|
| | Ablängen/Trennen trimming/cutting | Ablängen/Trennen trimming/cutting | Ablängen/Trennen trimming/cutting | Ablängen/Trennen trimming/cutting |
| Trennschere MS MaxiCut Cutting shears MS MaxiCut | MS MAX 15/200-5 ✓ MS MAX SP KD... | MS MAX 15/200-5 ✓ MS MAX SP VRX... | MS MAX 15/200-5 ✓ MS MAX SP PIK... | |
| Elektrohydraulische PIKCut Electrohydraulic PIKCut | | | MS PIKCut SP... ✓ | |
| Handbetriebene Trennschere PIKCut Manual shears PIKCut | | | HS PIKCut SP... ✓ | |
| Mobile Gitter-Kanalschere, elektrohydraulisch Portable Wire-tray Trunking shears, electrohydraulic | | | | MGKE M4 ✓ |

Antriebe Drives

| | Werkzeuge Tools | | | | | | | | | | | |
|--|--------------------------------|------------------------------------|----------------------------------|------------------------|------------------------------------|----------------------------------|------------------------|------------------------------------|----------------------------------|------------------------|------------------------------------|----------------------------------|
| | Ausklinken notching | Mulden stanzen punching hitches | Löcher stanzen punching holes | Ausklinken notching | Mulden stanzen punching hitches | Löcher stanzen punching holes | Ausklinken notching | Mulden stanzen punching hitches | Löcher stanzen punching holes | Ausklinken notching | Mulden stanzen punching hitches | Löcher stanzen punching holes |
| Stationärer Hydraulikzylinder Hydraulic notching punch | AS 15/300-3 ✓ AKW IK-VRX | ✓ WS MS | ✓ WS VL | ✓ AKW IK-VRX | | ✓ WS VRX VL | ✓ AWK PIK | | ✓ WS VL | ✓ AKW GK | | |
| Elektrohydraulischer Antrieb Electrohydraulic drive | EH AM2 60KN ✓ AKW IK-VRX | ✓ WS MS | ✓ WS VL | ✓ AKW IK-VRX | | ✓ WS VRX VL | ✓ AWK PIK | | ✓ WS VL | ✓ AKW GK | | |
| Handhydraulik-Antrieb Manual hydraulic drive | HH A 75 KN ✓ AKW IK-VRX | ✓ WS MS | ✓ WS VL | ✓ AKW IK-VRX | | ✓ WS VRX VL | ✓ AWK PIK | | ✓ WS VL | ✓ AKW GK | | |